



Radijator

INZENJERING

Heating Boiler serie K



Boilers of this series are made in batches of 18kW to 80kW. For their construction are used sheets 4 and 5 mm in the boiler quality standards JUS C1204 and H11 to DIN standard.

The analysis of cross-section of the boiler can be seen that in these boilers exchanger surface is mounted vertically, and that their dimensions and layouts provide a very long time hot flue gases through the boiler.

Measurement is established and much lower speed at the exit gases from the boiler and the lower the temperature at the entrance to the chimney in relation to other structures in our production program, and concludes that this structure has the highest efficiency. Boilers K series have a so-called bottom burning, and it is possible to fill the fuel to heating the door themselves without fear of extinguishing the fire. It has a great dish for firewood, so can give all-day use of boilers with one or two charges. In the back of the fireplace are set firebrick. They are heated to temperatures sufficient to burn hard combustion particles in flue gases.

The boiler was installed and the copper heat exchanger for connection valves for thermal insurance swelling.

This construction, when the fuel is wood, reaches a very high efficiency (over 80%), it has shown excellent results in the case of mixing wood and coal, and coal Heating should be avoided whenever its possible because the efficiency is less than "C" series.

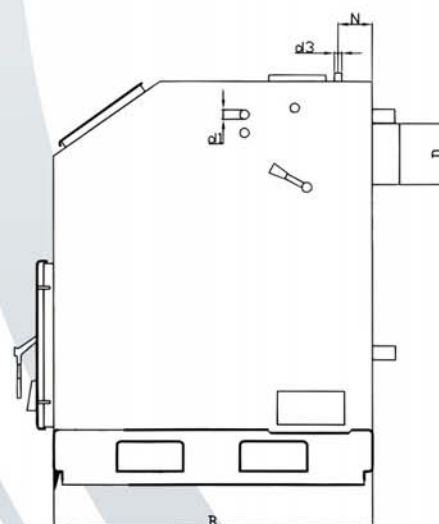
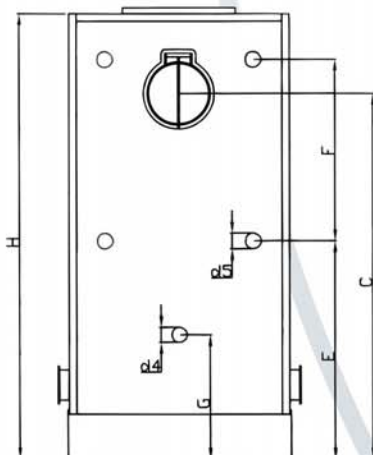
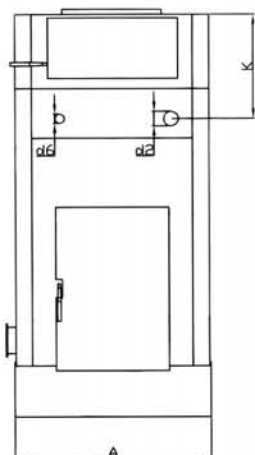
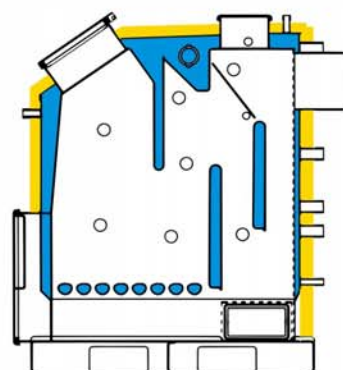

type of boiler	power	working pressure	test pressure	volume of water in the boiler	mass boiler	Necessary draught	Dimensions														
							A	B	H	C	D	E	F	G	N	K	d1	d2	d3	d4	d5
	kW	kPa	kPa	lccm	kg	Pa	mm														
K18	18	300	450	55	238	17	458	790	1005	810	160	408	528	300	100	300	1/2	3/4	1/2	1/2	1
K25	25	300	450	72	295	18	528	885	1105	910	180	504	530	300	64	310	1/2	3/4	1/2	1/2	1
K33	33	300	450	87	326	20	578	955	1160	905	200	576	497	316	80	315	1/2	3/4	1/2	1/2	5/4
K40	40	300	450	100	335	22	668	955	1215	1010	200	570	550	310	85	320	1/2	3/4	1/2	1/2	5/4
K50	50	300	450	140	449	23	768	952	1265	1055	200	623	548	311	90	320	1/2	3/4	1/2	1/2	5/4
K65	65	300	450	155	525	24	868	955	1305	1075	250	626	600	316	65	325	1/2	3/4	1/2	1/2	6/4
K80	80	300	450	180	555	24	918	1010	1305	1085	250	613	603	316	58	320	1/2	3/4	1/2	1/2	6/4